

# Table of Contents

1.	Intended Use	5
2.	Accepted Symbols and Signs	6
3.	About the SyqeAir Inhaler	7
4.	Special Warnings Regarding the Use of Medicinal Cannabis	7
5.	Product Description	8
5.1	Contents of the package	8
5.2	Inhaler parts	9
6.	Warnings	10
7.	Assembly and Replacement of the Mouthpiece	10
8.	Insertion and Removal of the Cartridge	13
8.1	Cartridge insertion	12
8.2	Cartridge removal	16
9.	Selecting Language	17
10.	Inhalation Training	18
11.	Activating the Inhaler and Selecting Your Dose	21
12.	Inhalation	23
13.	Turning Off the Inhaler	26
14.	Charging the Battery	26
15.	Cleaning Instructions	28
15.1	Inhaler cleaning instructions	28
15.2	Mouthpiece cleaning instructions	28
16.	Troubleshooting	29
17.	Hard-Reset the Inhaler	32
18.	Menu	32
19.	Last Inhalation	33
20.	Technical Data	34
21.	Electro Magnetic Compatibility (EMC) Compliance	35
22.	Customer Service	36

# 1.

## Intended Use







Before use, ensure these instructions have been read and are always kept available.

This manual contains information about the use of the SyqeAir Inhaler. For more information about the use of the SyqeAir Cartridge, please refer to the Patient's Leaflet found in the cartridge package. If you have any questions about the performance or usability of this product, please contact your healthcare provider (HCP) prior to use.

---













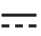

The SyqeAir Inhaler is a medical device intended for use with a SyqeAir Cartridge. The Inhaler is a metered-dose aerosol delivery system with selective dosing capabilities. The inhaler and cartridge are intended to be used by patients with medical documentation (i.e., authorization form) for the use of medicinal cannabis from their health care providers.

### General Warnings

-  **Use the Inhaler with the Mouthpiece and Cartridge only.**
  -  **The monthly therapeutic dosage will be determined by your healthcare provider (HCP).**
  -  **Use the inhaler after receiving suitable training and instruction by your HCP.**
  -  **The inhaler is intended for oral use and is not to be used in any other manner.**
  -  **Store the Inhaler in a closed, dry, and clean place, out of the reach of children and in accordance with the instructions provided.**
  -  **Service for the Inhaler will only be given by registered service providers. In no case should the inhaler be disassembled in an attempt to repair it. Provision of service and repairs by an unauthorized entity may cause personal injury and/or damage to the inhaler.**
  -  **Attention: Use and store the Inhaler only under the operating and storage conditions provided in this User's Manual.**
-

## 2. Accepted Symbols and Signs

The following signs appear in the User's Manual, on the packaging, and on the various labels:

 Please read the instructions before use	 Keep away from direct sunlight
 Do not use if the packaging is damaged	 Avoid contact with liquids
 Manufacturer's details	IP22 Protection from solid particles approximately 12 mm in size Protection from water spray less than 15 degrees from vertical
 Manufacturing date	 DC current
 Applied part type B	 Contact information for support and service
 Serial no.	 Cannabis product that contains THC in a concentration greater than 10 micrograms per gram
 Batch no.	
 15°C / 25°C Temperature conditions	 Dispose of this waste of electrical and electronic components separately. The inhaler contains a built-in rechargeable lithium-ion battery that must be discharged before disposal.



## 3. About the SyqeAir Inhaler

The SyqeAir Inhaler (hereinafter “the inhaler”) is an inhaler which delivers metered-doses of cannabis via thermal technology and airflow control; aligning them to the manner in which the user inhales, in real-time. The inhaler is for single patient use. The inhaler may be linked to the SyqeAir app, complementing the treatment with the inhaler.

The inhaler is manufactured by Syqe Medical Ltd - 14 Hatchiya St., Tel-Aviv, 6816914, Israel, hereinafter, “the company” or “Syqe”.

## 4. Special warnings regarding the use of medicinal cannabis

**WARNING: Do not use if pregnant or breastfeeding. Substances in cannabis are transferred from the mother to child and can harm your baby.**

-  **For more information read the Patient Leaflet SyqeAir Cartridge, found in the cartridge package.**
-  **Attention: medicinal cannabis is a controlled substance, and its legal status may be different in different countries. If you are travelling to other countries, check that it is legal for you to be in possession of medicinal cannabis and/or use it in those countries. This includes countries you are travelling through. Driving while using medicinal cannabis may be illegal in some countries.**
-  **Please note: there is no information available about the safety and efficacy of the use of the inhaler in children.**

## 5. Product Description

### 5.1 Contents of the package



### 5.2 Inhaler parts

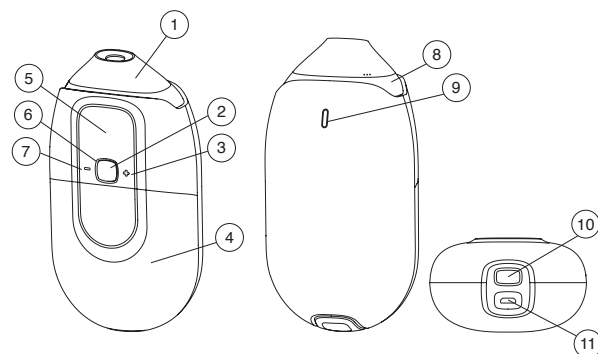

## 6. Warnings

- ⚠ Do not use the SyqeAir Inhaler if it is broken, cracked, or does not work properly. If any damage is found, please refer to Customer Service before use. Contact information may be found in the Customers Service (Chapter 20).
- ⚠ The use of this inhaler under conditions different than operation and storage conditions described in this manual may harm the effectiveness of your dosing.

## 7. Assembly and replacement of the mouthpiece

- ⚠ Do not store the inhaler without a mouthpiece inserted.
  - ⚠ Do not use the same mouthpiece with more than 3 cartridges.
  - ⚠ Do not turn or remove the mouthpiece during inhalation or at the time that the inhaler is “ready for inhalatio”. This action may cause damage to the inhaler
- ⚠ Attention: make sure the mouthpiece is clean. If the mouthpiece is not clean, clean according to the cleaning instructions for the mouthpiece (Chapter 15.2).
- ⚠ Attention: wash your hands before inserting the mouthpiece into the Inhaler.
- ⚠ Attention: make sure that the mouthpiece is whole, intact and undamaged before assembly. In case there is a defect in the mouthpiece, please contact Customer Service before use.

### 7.1 Insertion of Mouthpiece

- 7.1.1 Open the mouthpiece box.
- 7.1.2 Take the mouthpiece out of the packaging.
- 7.1.3 Hold the mouthpiece at its upper part (Figure 3).
- 7.1.4 Insert the mouthpiece tube (Figure 3 (1)) into the mouthpiece base (Figure 3 (3)) found in the upper part of the inhaler when the gasket (Figure 3 (2)) is facing the front of the inhaler.

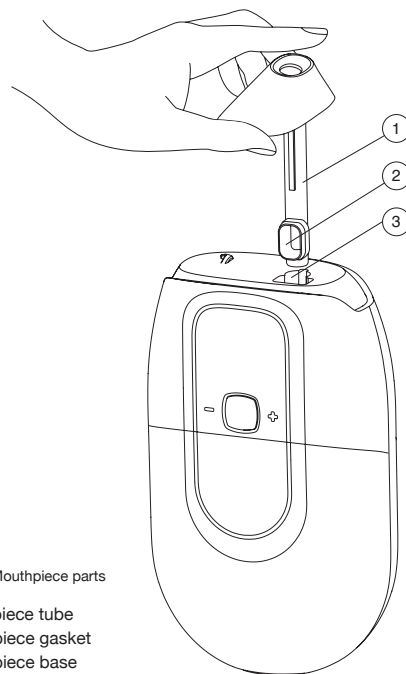

Figure 3 - Mouthpiece parts

- 1. Mouthpiece tube
- 2. Mouthpiece gasket
- 3. Mouthpiece base

- 7.1.5 After the mouthpiece is completely inserted, turn the mouthpiece 90 degrees clockwise until it stops (Figure 4).

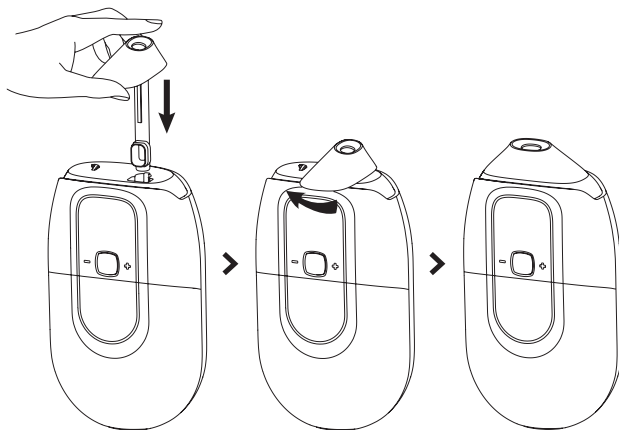

Figure 4 - Insertion of mouthpiece, 90 degree rotation

- 7.1.6 If the mouthpiece is not in place, a 'Mouthpiece not in place' screen will appear (Figure 5) and the front indicator light will turn orange (Figure 2 (6)).

In this case, remove the mouthpiece according to the instructions in Chapter 7.2 and return it according to the instructions in Chapters 7.1.3-7.1.5.



Figure 5 - 'Mouthpiece not in place' screen

## 7.2 Removal of mouthpiece

- 7.2.1 Turn the mouthpiece on its upper part (over the dots, see Figure 6), 90 degrees counterclockwise until it stops (Figure 6).

- 7.2.2 Hold the mouthpiece and gently pull upwards until it is completely removed (Figure 6).

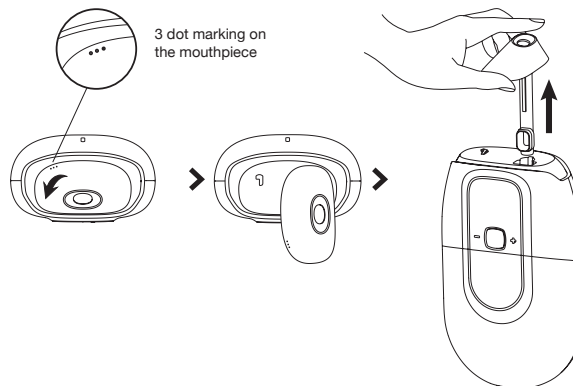

Figure 6 - Removal of mouthpiece

# 8. Insertion and Removal of the Cartridge

## ⚠ Read the Patient's Leaflet carefully - SyqeAir Cartridge

- Open the cartridge box and remove the leaflet and the aluminum foil containing the cartridge.
  - Open the aluminum foil.
- ⚠ Check the expiration date and the integrity of the cartridge before use and make certain that the number of remaining doses is 60 (Figure 7 (1)).

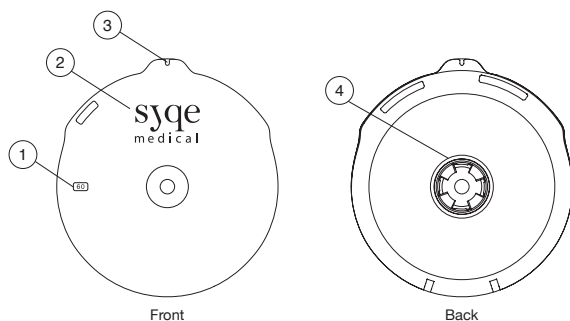
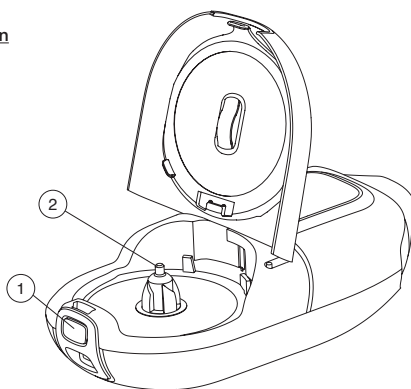

Figure 7 - cartridge

1. No. of remaining doses
2. Text 'syqe medical'
3. Red mark
4. Back axle

### 8.1 Cartridge insertion

Figure 8 - Cartridge compartment



1. 'Open cover' button
2. 'Blue' rotation axle

- 8.1.1 Open the cartridge compartment cover by pressing the 'Open cover' button located at the bottom of the device (Figure 8 (1)).

- 8.1.2 Make sure that the cartridge compartment is undamaged and empty. If there is a used cartridge inside the cartridge compartment, remove it in accordance with the cartridge removal instructions (Section 8.2), before inserting a new cartridge.

- 8.1.3 Hold the cartridge so that the text 'Syqe Medical' (Figure 7, (2)) is facing towards you, the red mark (Figure 7 (3)) faces towards the mouthpiece and the back axle (blue) (Figure 7 (4)) is placed above the rotation axle (blue) (Figure 7 (2)).

- 8.1.4 After insertion into the cartridge compartment, press and rotate the cartridge to the right, clockwise, until a click is heard (Figure 9).

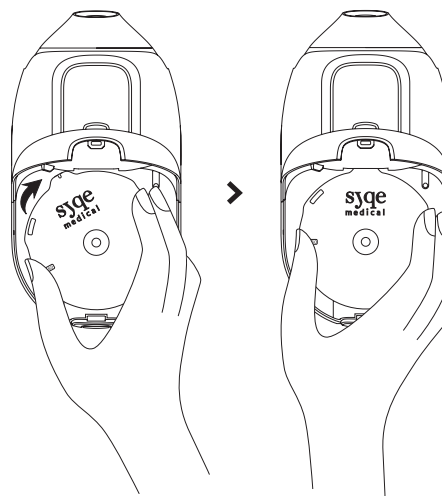

Figure 9 - Insertion of cartridge

- 8.1.5 Now close the cartridge cover until a click is heard. If the cartridge cover does not close, make sure that the cartridge is locked in securely by pressing and turning it towards the right until a click is heard.

- 8.1.6 If the cartridge cover is not properly closed, the screen 'Cartridge compartment cover open' will appear on the display (Figure 42). In this case, repeat the instructions in sections 8.1.3-8.1.5 and make sure the cartridge is inserted correctly.

## 8.2 Cartridge removal

- 8.2.1 Open the cartridge compartment cover by pressing the 'Open cover' button located at the bottom of the device (Figure 2 (10)).
- 8.2.2 After opening the cartridge compartment cover, hold both sides of the cartridge (Figure 10), rotate counterclockwise until it is released and then pull it outwards.

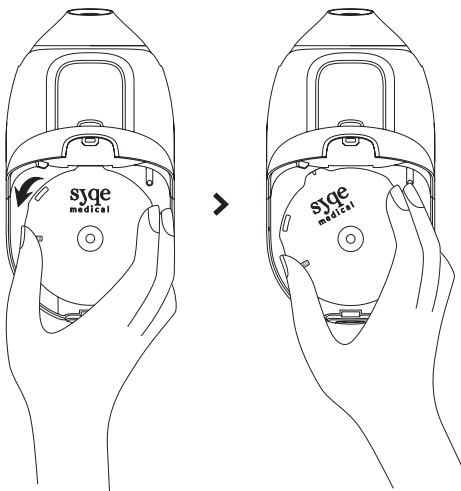

Figure 10 - Removal of Cartridge

- 8.2.3 Do not dispose of the Cartridge in the waste bin or sewage. Ask your health care provider or patient support team how to properly dispose of this product.

# 9. Selecting language

On the first operation of the inhaler and/or after a reset of the inhaler (Chapter 18) you can select your preferred language.

- 9.1 Press the ON button located at the front of the inhaler (see Figure 2 (2)) to turn the inhaler on.
- 9.2 At the present a 'Select Language' screen will appear (see Figure 11).
- 9.3 Your interface language may be changed by pressing the plus (+) and minus (-) buttons.
- 9.4 Approve your selected language by pressing the ON button (see Figure 2 (2)).

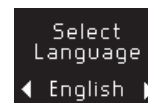

Figure 11 - 'Select Language' screen



## 10. Inhalation training

During first-time use and/or after hard resetting the inhaler (Chapter 18), you may perform a short inhalation training session which purpose is to help you learn the optimal method for inhaling from the SyqeAir Inhaler.

⚠ Attention: the training inhalations are for training purposes only and no active ingredient is transferred to you during these inhalations.

⚠ Attention: make sure the battery is charged before using the inhaler. If the battery is not charged, charge it according to the instructions in Chapter 14.

- 10.1 Following language selection (see Chapter 9) the Training Mode Selection screen appears (Figure 12), at this point in time you should select 'Yes' if you wish to perform a training inhalation session.

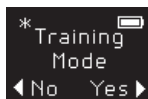

Figure 12 -  
'Training Mode  
Selection' screen

- 10.2 For confirmation and operation of training mode, press the plus (+) button (Figure 2 (3)). To continue without the training mode, press the minus (-) button (Figure 2 (7)). After confirmation of the training mode, the 'Training Mode activated' screen will appear (Figure 13). Throughout the training mode the front indication light (Figure 2 (6)) will turn purple and an asterisk symbol (i.e., \*) will appear in the upper left corner of the screen (Figure 2 (5)).

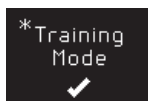

Figure 13 -  
'Training mode  
activated' screen

- 10.3 Now, the 'Ready to INHALE' [training] screen will appear (Figure 14). Training mode consists of 4 training inhalations and will display in which of the 4 inhalations you are currently at. To exit the training mode at any stage, hold the ON button pressed for 4 seconds (Figure 2 (2)), until the inhaler shuts off. In order to activate the inhaler again, repeat the instructions in sections 10.1-10.3.



Figure 14 -  
'Ready to train  
Inhalation' screen

- 10.4 Exhale, before performing an inhalation (Figure 25).

- 10.5 After exhaling, place your lips on the mouthpiece (Figure 26) and inhale in a uniform manner for approximately 3 seconds. Towards the end of the inhalation, you will feel resistance in the air flow, but do not stop inhaling until the inhalation indicator light turns off (Figure 2 (9)).

- 10.6 At the end of a successful inhalation, the inhaler indicator light will turn off (9), and the 'SUCCESSFUL Inhalation' [training] screen will appear (Figure 15).



Figure 15 -  
'Successful Inhalation  
(training)' screen

- 10.7 In the event the inhalation was unsuccessful, 3 beeps will be heard, the inhalation indicator light (9) will turn orange and one of the following screens will appear:

- A. 'Weak training inhalation' screen (Figure 16)  
Meaning - Attention, Weak inhalation.  
How to improve the quality of the inhalation?  
Inhale at a steady pace.



Figure 16 -  
'Weak training  
inhalation' screen

B. 'Short training inhalation' screen (Figure 17)

Meaning - Attention, the inhalation period is shorter than 3 seconds.

How can the quality of the inhalation be improved? In the next inhalation, inhale at a steady pace for a period of 3 seconds and until the indicator light on the back of the inhaler turns off (Figure 2 (9)).



Figure 17 - 'Short training inhalation' screen

C. 'Forceful training inhalation' screen (Figure 18)

Meaning - Attention, Inhalation is too forceful. How can the quality of the inhalation be improved? Inhale at a steady pace and force.



Figure 18 - 'Forceful training inhalation' screen

D. 'Unsteady training inhalation' screen (Figure 19)

Meaning - Attention, the inhalation is not uniform. How can the quality of the inhalation be improved? Inhale at a steady rate for a period of 3 seconds until the green light on the back of the inhaler turns off (Figure 2 (9)).



Figure 19 - 'Unsteady training inhalation' screen

10.8 After completing 4 training inhalations, the 'Repeat training' screen will appear (Figure 20) and you may select either to activate additional training or to continue usage without additional training.

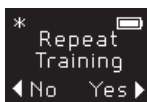

Figure 20 - 'Additional training inhalation' screen

# 11. Activating the inhaler and selecting your dose

## Prior to activating the inhaler:

- Insert the mouthpiece into the inhaler as indicated in the 'Mouthpiece insertion instructions' in Chapter 7.1.
- Insert the cartridge as indicated in the 'Cartridge insertion instructions' in Chapter 8.1.
- Select your preferred language as indicated in 'Language selecting instructions' in Chapter 9.
- Inhalation training may be practiced without vaporization of the active ingredients. The goal of the training is to assist you in learning how to correctly inhale from the inhaler. For inhalation training instructions, please see Chapter 10.

⚠ Make sure that the battery is charged before using the inhaler. If the battery is deployed, charge it according to the instructions in Chapter 14.

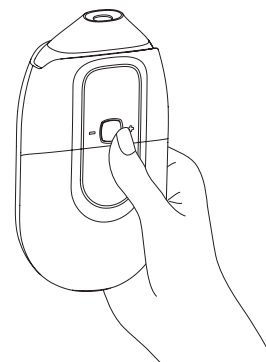

Figure 21

- 11.1 To activate the inhaler, press the ON button located at the front of the inhaler (see Figure 2 (2)). The 'Opening' screen will be displayed for a few seconds (Figure 22). Both indicator lights will turn white (Figure 2 (6)(9)) and a single beep will be heard.



Figure 22 -  
'Opening' screen

- 11.2 In the following 2 seconds, the inhalation light indicator (Figure 2 (9)) will turn off and the 'Home' screen (Figure 23) will appear, displaying the number of remaining doses, dosage setting, and battery status.

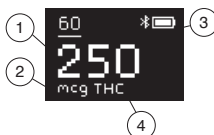

Figure 23 -  
'Home' screen

1. Number of remaining doses
2. Dosage indicator
3. Battery status
4. Active ingredient THC / CBD

- \* The Number of remaining doses indicator will blink when there are 5 doses or less remaining.
- \* The Battery status indicator will blink when the battery is low.

- 11.3 Now you may select your preferable dosage using the plus (+) and minus (-) buttons. The dosage may be changed from the Home screen only (see Figure 23).

- \* Your dosage control ability depends on the Inhaler's software version. For more information, please contact Customers Service.

- 11.4 To prepare a dose for inhalation, press the ON button once again. The 'Ready to INHALE' screen will be displayed (Figure 24) and the inhalation indicator light will turn green (Figure 2(9)) as well as the front indicator light (Figure 2 (6)).



Figure 24 - 'Ready to  
inhale' screen

- 11.5 Begin inhalation.

## 12. Inhalation

- ⚠ Attention: Inhale while sitting (or at least in a raised position of 45°).
- ⚠ Do not block the air intake.
- ⚠ Do not rotate or remove the mouthpiece during inhalation. This action may cause damage to the inhaler.

- 12.1 Before beginning an inhalation - exhale (Figure 25).

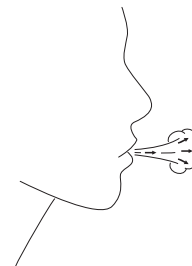

Figure 25 -  
Exhale before  
beginning an  
inhalation, exhale

- 12.2 After exhaling, place your lips on the mouthpiece (Figure 26) and inhale at a uniform rate for at least 3 seconds. Towards the end of the inhalation you will feel a resistance in the air flow, **but do not stop inhaling until the inhalation indicator light turns off** (Figure 2 (9)).

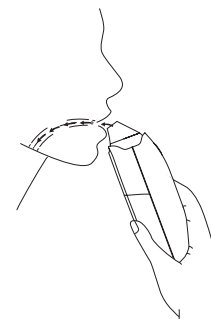

Figure 26 - Inhalation

- 12.3 At the end of a successful inhalation, the inhalation indicator light will turn off (Figure 2 (9)) and the 'Successful Inhalation' screen will appear (Figure 27).



Figure 27 - 'Successful Inhalation' screen

- 12.4 In the event of an unsuccessful inhalation, 3 beeps will be heard, the inhalator indicator light (Figure 2 (9)) will turn orange and one of the following screens will appear:

- A. 'Weak Inhalation' screen (Figure 28)  
Meaning - Attention, Inhalation is incorrect; the desired dosage was not delivered.



Figure 28 - 'Weak Inhalation' screen

- B. 'Short Inhalation' screen (Figure 29)  
Meaning - Attention, the period of inhalation was shorter than 3 seconds, a partial dosage was delivered and therefore you should wait 20 minutes and assess whether there is need for an additional inhalation.



Figure 29 - 'Short Inhalation' screen

- C. 'Forceful Inhalation' screen (Figure 30)  
Meaning - Attention, Inhalation was too forceful and the desired dosage was not delivered.



Figure 30 - 'Forceful Inhalation' screen

- D. 'Unsteady Inhalation' screen (Figure 31)  
Meaning - Attention, the inhalation was not uniform and the desired dosage was not delivered.



Figure 31 - 'Unsteady Inhalation' screen

- 12.5 If an incorrect inhalation occurs, one of the two following instruction screens will be displayed:

- A. 'Wait 20 minutes for an additional inhalation' screen (Figure 32)

A 'Wait 20 minutes' screen is displayed when an incorrect inhalation has been detected and a partial dose was delivered. Wait 20 minutes and assess whether there is a need for an additional inhalation.



Figure 32 - 'Wait 20 minutes for an additional inhalation' screen

- B. 'Press to Inhale Again' screen (Figure 33)

The 'Press to Inhale again' screen is displayed when an incorrect inhalation has been detected and no dose was delivered. You should inhale again, by pressing the ON button (Figure 2 (2)). **Attention!** to improve the quality of the inhalation, exhale before inhaling, then place your lips on the mouthpiece and inhale at a uniform rate for a period of 3 seconds until the inhalation indicator light at the back of the inhaler, turns off (Figure 2 (9)).



Figure 33 - 'Press to Inhale Again' screen

- 12.6 If within 30 seconds of preparing a dose, an inhalation was not been performed, a 'No inhalation occurred' screen will appear (Figure 34) and the inhalation indicator light will turn off. To return to the 'Ready for inhalation' screen, press the ON button and continue according to the instructions in Chapter 13. If within 7 seconds the ON button has not been pressed - the inhaler will turn itself off.



Figure 34 - 'No Inhalation Occurred' screen

\* In the event that an inhalation was not performed, the dose will be kept for future use.

## 13. Turning off the inhaler

The inhaler turns off automatically after a number of seconds when left unused. The inhaler may also be turned off by holding the ON button for 4 seconds (Figure 2 (2)).

## 14. Charging the battery

- ⚠ Only use the wall adaptor and USB cable supplied by Syqe Medical. Use of another adaptor or cable may cause damage to the inhaler or may cause you harm.
- ⚠ Before charging the battery of the Inhaler, always make sure that the micro USB cable and wall adaptor are not damaged. Keep the micro USB cable out of the reach of children. In addition, do not store the wall adaptor or micro USB cable near liquids or heat sources. Do not pull the micro USB cable over sharp edges, smash, or fold it. If the micro USB cable or the wall adaptor appear damaged, contact Customer Service.
- ⚠ Attention, if the battery status indicator icon (Figure 21) displays a low battery, charge the battery before use. It is recommended to charge the battery prior to full battery depletion.

- 14.1 The battery status indicator is displayed on the 'Home' screen (see Figure 23). When the battery is too weak for an inhalation, a 'Low Battery' screen will appear (Figure 36), the front indicator light (Figure 2 (6)) will turn orange and the inhaler will shut off after a few seconds.



Figure 36 -  
'Low Battery' screen

- 14.2 Connect the micro USB \ Type-C cable to the USB port in the wall adaptor and the micro USB \ Type-C port at the bottom of the inhaler (Figure 37).

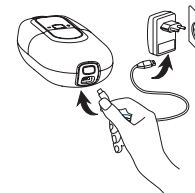

Figure 37 - Charging the battery

- 14.3 Connect the wall adaptor to an electrical outlet (100-240 V).

- 14.4 A 'Charging' screen will appear indicating that the inhaler is being charged (Figure 38), after 30 seconds, the screen will turn off and the battery will continue charging.



Figure 38 -  
'Charging' screen

- 14.5 When the battery is fully charged, the 'Battery is fully charged' screen will be displayed (Figure 39).



Figure 39 -  
'Battery fully charged'

- 14.6 Using the inhaler is impossible during battery charging. During an attempt to inhale while the inhaler is plugged into the charger, an audible double beep will be heard, a 'Disconnect Charger' screen will appear (Figure 40) and the front indicator light will light up orange (Figure 2 (6)).



Figure 40 - 'Disconnect  
Charger' screen

## 15. Cleaning Instructions

- ⚠ Do not clean the inhaler during use or while charging.
- ⚠ The Inhaler is not water-resistant. Do not expose it to water or any liquid. Exposure to liquids may cause permanent damage to the inhaler's interior electrical circuits.
- ⚠ Attention: Only use 70% alcohol solution. Use of other cleaning solutions may cause damage to the inhaler.

### 15.1 Inhaler cleaning instructions

The body of the inhaler may be cleaned as needed, in the following manner:

15.1.1 Wipe the outer part of the inhaler thoroughly using a cloth soaked with a 70% alcohol solution.

15.1.2 Let the inhaler air-dry for at least 2 hours prior to using.

### 15.2 Mouthpiece cleaning instructions

15.2.1 It is recommended to clean the mouthpiece at least once a week.

15.2.2 Clean the exterior part of the mouthpiece only, using a cloth soaked with a 70% alcohol solution (Figure 41).

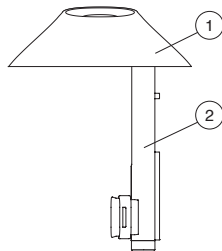

Figure 41 - Cleaning the mouthpiece

- 1. Area which may be cleaned
- 2. Area which should not be cleaned

## 16. Troubleshooting

- ⚠ Do not perform an inhalation when the inhaler is malfunctioning. Try to solve the problem according to the guidelines below, if the problem is not solved, contact Customer Service for assistance. Contact information may be found in Chapter 22.

### 16.1 Open cartridge compartment cover

When the cartridge compartment cover is open, the front indicator light will light up orange (Figure2 (6)), and an 'Open Cartridge Compartment Cover' screen will appear (Figure 42).

**Solution** - close the cartridge compartment cover according to the instructions in Section 8.1.5.

Inhalation cannot be performed while the cover is open.



Figure 42 -  
'Open Cartridge  
Base Cover'

\* Attention! Do not open the cartridge compartment cover while the 'Ready for inhalation' screen is displayed or during inhalation. This may cause damage to the inhaler. If the cartridge compartment cover is opened during use, the inhaler will stop administering the dose, a long beep will be heard, the front indicator light will turn orange, and 'Cartridge compartment cover open' screen will be displayed (Figures 42).

### 16.2 No cartridge

When there is no cartridge in the cartridge compartment, the front indicator light will turn orange (Figure 2 (6)), and the 'No Cartridge' screen will be displayed (Figure 43).

Solution - insert a new cartridge into the cartridge compartment according to instructions in Chapter 8.



Figure 43 -  
'No cartridge' screen

### 16.3 Empty cartridge

Once all the doses have been used and the cartridge is empty, the number zero (0) will appear on the 'Home screen' (Figure 21 (1)) and the inhaler will not operate.

Solution - replace the cartridge with a new one, according to Chapter 8.

\* Attention! If you press the ON button before replacing the cartridge, the 'Replace Cartridge' screen will be displayed (Figure 44) and a beep will be heard.



Figure 44 -  
'Replace cartridge' screen

### 16.4 Missing mouthpiece / mouthpiece inserted incorrectly

When the inhaler is missing a mouthpiece or the mouthpiece is incorrectly inserted, the front indicator light will turn orange, and the 'Insert Mouthpiece' screen will be displayed (Figure 45).

Solution - insert a mouthpiece in the inhaler according to the Replace Mouthpiece instructions (see Chapter 8).

\* Attention! Do not attempt to turn or remove the mouthpiece while the 'Ready to inhale' screen is displayed or during inhalation, if you do so, a long beep will be heard for a period of 3 seconds, the front indicator light will turn orange, and the 'Insert Mouthpiece' screen will be displayed (Figure 45).



Figure 45 -  
'Insert Mouthpiece' screen

### 16.5 General Error

If there is an error not defined above, an indicator light will turn orange (Figure 2 (6) (9)), a long beep will be heard, and 'Error' screen will be displayed along with the error number (Figure 46). Please note this Error number for Customer Service reference.

Solution - If 'Error' is displayed on the screen, try to restart the inhaler by turning it off (Chapter 13) and then on again (Chapter 11.1). If the General Error screen still appears, contact Customer Service.

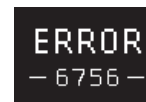

Figure 46 -  
'General Error' screen

### 16.6 Overheating

If the inhaler overheats - an indicator light (Figure 2 (6), (9)) will turn orange, a beep will be heard, the 'Overheated' screen will be displayed (Figure 47), followed by a 'Wait 5 min' screen (Figure 48) and the inhaler will turn off automatically. Solution - Wait 5 minutes for the inhaler to cool down before attempting to use it.

If you are unable to turn the inhaler on, connect the inhaler to the charger (Chapter 14).

\* Attention! If the 'Overheating' screen is displayed multiple times, please contact Customer Service.



Figure 47 -  
'Overheated' screen



Figure 48 - 'Wait 5 min' screen

### 16.8 Unsuccessful inhalations:

- 'Weak Inhalation' (Figure 28) - Details can be found in Section 12.4 a.
- 'Short Inhalation' (Figure 29) - Details can be found in Section 12.4 b.
- 'Strong Inhalation' (Figure 30) - Details can be found in Section 12.4 c.
- 'Unsteady Inhalation' (Figure 31) - Details can be found in Section 12.4 d.

## 17. Hard-reset the inhaler

In the event you have not succeeded in solving one of the errors using the troubleshooting steps above, hard-reset the inhaler. To hard-reset the inhaler, hold the ON (Figures 2 (2)) button and the Minus (-) button (Figure 2 (7)) simultaneously for 10 seconds.

## 18. Menu

If you want to perform a Training inhalation (see Figure 50 - Training selection mode), change the language (see Figure 51 - language selection) or view last inhalation details (see Figure 49 - Last Inhalation), go the MENU.



Figure 49 - Last Inhalation



Figure 50 - Training selection mode



Figure 51 - Language selection

- 18.1 Press the Main button (Figures 2 (2)) and the Plus (+) button (Figure 2 (7)) simultaneously.

- 18.2 A MENU screen shall appear that contain: "Last Inhalation", "Training", or "Language".

- 18.3 You can switch between the options by pressing the Plus (+) and Minus (-) buttons respectively.

- 18.4 Approve action by pressing the Main button (Figure 2(2)).

## 19. Last Inhalation

To view the last inhalation details, go to MENU.

- 19.1 Press the Main button (Figures 2 (2)) and the Plus (+) button (Figure 2 (7)) simultaneously.

- 19.2 A "Last Inhalation" screen will appear.

- 19.3 To view "Last Inhalation" details (Figure 49 - Last Inhalation), approve the action by pressing the Main button (Figures 2 (2)).

- 19.4 Last inhalation data will now appear:
1. When the last inhalation was performed
  2. Inhalation dosage and active ingredient THC / CBD
  3. The inhalation result

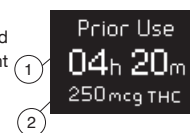

Figure 52 - Last Inhalation, Prior Use



## 20. Technical Data

1	Inhaler dimensions (length, width, thickness)	Approx. 150 X 80 X 50 (mm)
2	Weight including inhaler, cartridge, and mouthpiece	approx.260 (g)
3	Environmental, conditions and storage	15-25 [°C]
	Operating	15-25 [°C]
	Storage between uses (without Cartridge)	-20-50 [°C]
	Transportation without Cartridge	-25-70 [°C]
	Air pressure (operating, storage and transportation)	1005 hPa
4	IP Classification	Protection from solid particles $\geq 12.5$ mm in size, and from dripping liquids (when 15° tilted)
5	Electrical adaptor:	
	Electrical usage	10 [W]
	Output	5V@2A (10W)
	Input	50-60 [Hz] / 100-240 [V], 0.3 A
	Adaptor part number	WR9QA2000USBM6B3115
	Cable connector type	Micro USB \ Type C
	Cable length	1m
	Protection class	Class II / double insulation
6	Applied part type	B
7	Battery type Battery current rating	Lithium - Ion Polymer 20C

## 21. Electro Magnetic Compatibility (EMC) Compliance

This equipment has been tested and found to comply the requirements of the IEC 60601-1-2 standard for medical devices.

The SyqeAir Inhaler is suitable for use in a home environment, within a distance of 30 cm from electric / electronic equipment.

- ⚠ Use of a power adapter or cable other than those provided by SyqeAir could result in increased electromagnetic emissions or decreased electromagnetic immunity of the Inhaler and result in improper operation.
- ⚠ Portable RF communications equipment (including peripherals such as antenna cables and external antennas) should be used no closer than 30 cm to the Inhaler, including the Inhaler Cable and Adapter. Otherwise, degradation of the performance of the inhaler could result. In case of interference, move the device to a location away from the source of interference.

## 22. Customer Service

**You can contact customer service  
in the following ways:**

Syqe Medical Israel:  
Phone: \*2064  
Email: [support@syqe.co.il](mailto:support@syqe.co.il)

---

Canada:  
Phone: 1-888-511-SYQE(7973)  
Email: [patientsupport@syqe.com](mailto:patientsupport@syqe.com)

---

Australia:  
Phone: (03) 9117 9017 Australia wide  
Email: [care@kensana.com](mailto:care@kensana.com)

---

**[www.syqe.com](http://www.syqe.com)**

